

203 South Church Street

GREENSBORO, NC 27401

DOWNTOWN OFFICE SPACE

FOR LEASE



±3,300 SF office space located in the heart of downtown Greensboro, featuring a conference room, private executive office, open floor plan, group meeting space and two kitchenettes. The office was previously occupied by Action Greensboro, co-tenants include Frank L. Blum Construction and Eventful. Floor to ceiling windows, break areas, and a projector screen create a unique work environment. Common areas feature a reception area, bathroom and a break room. Lease includes four dedicated parking spaces, location has great proximity to downtown restaurants, retail, and parks.

LEARN MORE ABOUT THIS PROPERTY



Nick Gonzalez

E Nick@LTPcommercial.com

M 305.979.3440

P 336.724.1715



Jordan Cooper

E Jordan@LTPcommercial.com

M 303.717.3160

P 336.724.1715

203 South Church Street

GREENSBORO, NC 27401

DOWNTOWN OFFICE SPACE

FOR LEASE



- ± 3,300sf located in the heart of downtown Greensboro
- Features a conference room, private executive office, open floor plan, group meeting space, and two kitchenettes
- Four dedicated parking spaces
- Great proximity to downtown restaurants, retail and parks
- **Lease Rate: \$18.00psf, Full Service**

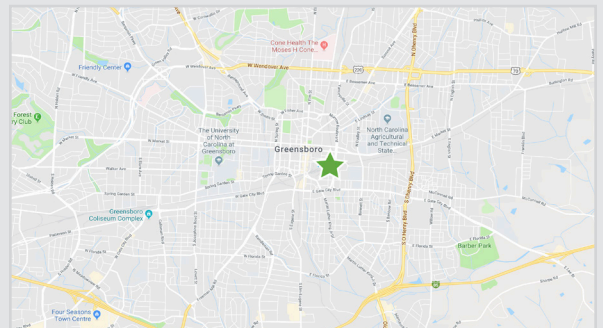

203 South Church Street

GREENSBORO, NC 27401

DOWNTOWN OFFICE SPACE

FOR LEASE



TO LEARN MORE ABOUT THIS PROPERTY, CONTACT:

Nick Gonzalez
Nick@LTPcommercial.com

Jordan Cooper
Jordan@LTPcommercial.com

203 South Church Street

GREENSBORO, NC 27401

DOWNTOWN OFFICE SPACE

FOR LEASE

FLOOR PLAN

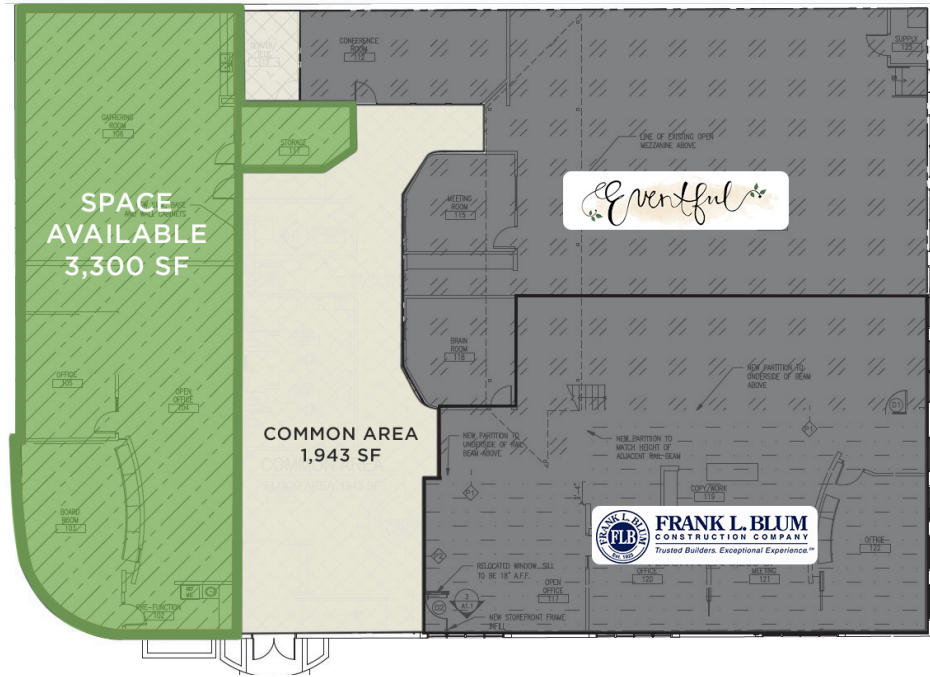

LOCATION

Address 203 South Church Street

City Greensboro Zip 27401 Co. Guilford

PROPERTY DETAILS

Property Type	Office	Available sf ±	3,300	Year Built	1953	Restrooms	2
Building sf ±	11,700	# Floors	1	Year Renovated	2005	Parking	4 Spaces

TAX INFORMATION

Zoning CB Tax PIN 7864755676

PRICING & TERMS

Lease Rate \$18.00 Lease Type Full Service Terms \$4,950/Month

The information contained herein has been taken from sources deemed to be reliable. Linville Team Partners makes no representation or warranties, expressed or implied, as to the accuracy of this information. All information in this document is subject to verification prior to purchase or lease.

TO LEARN MORE ABOUT THIS PROPERTY, CONTACT:

Nick Gonzalez
Nick@LTPcommercial.com

Jordan Cooper
Jordan@LTPcommercial.com